



The Faribault

www.FitzkeConstruction.com

info@FitzkeConstruction.com

612.424.2569

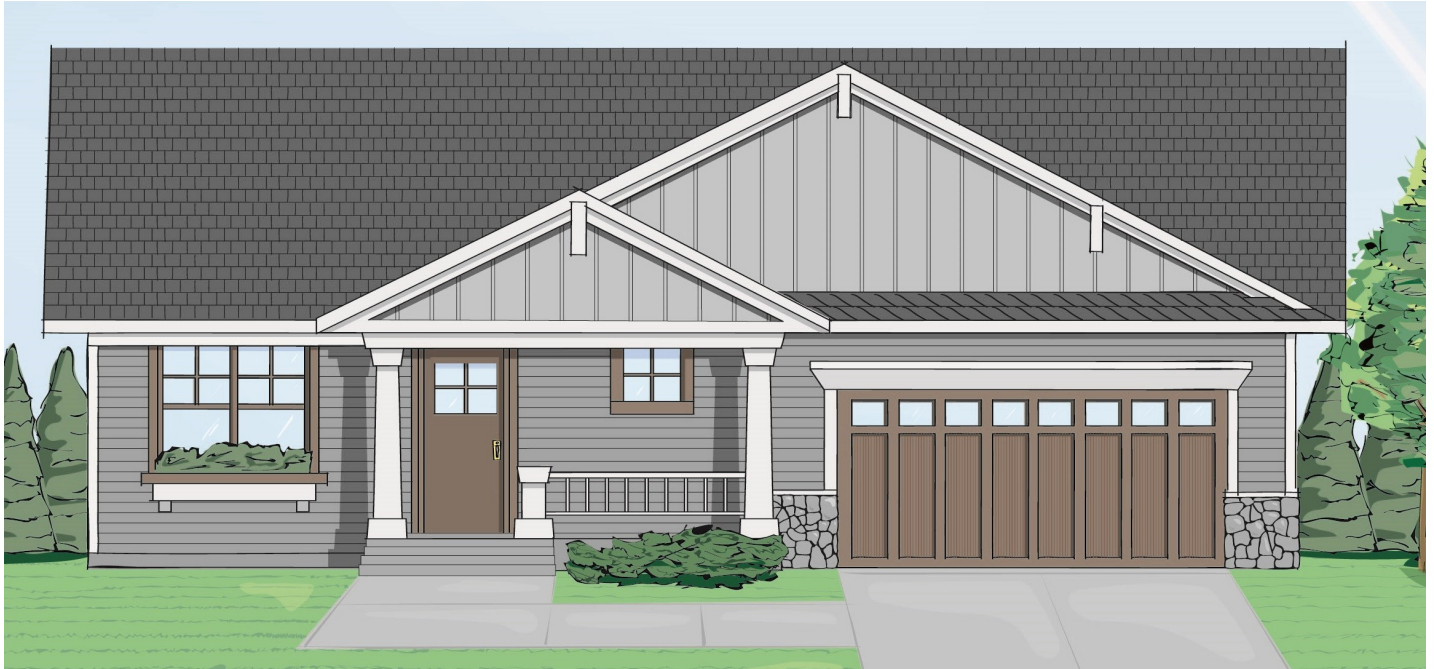

- Luxury one level living with 10' ceilings in the great room
- Open and Bright floor plan included designer kitchen with granite countertops and large eat at island.
- Master Suite with expansive walk in closet. Master bath includes barrier free shower entrance
- Second bedroom and bathroom on main level.
- MN Green Path energy rating with emphasis on state of the art energy features
- Low Maintenance exterior with LP Smartside Siding on the front and 30 year architectural shingles



Copyright Fitzke Construction 2021



MN LIC # BC635511

fitzke

Construction...

The Faribault

Main Floor 1584 sqft

1500 Optional sqft finish lower level

www.FitzkeConstruction.com

info@FitzkeConstruction.com

612.424.2569



Main Level

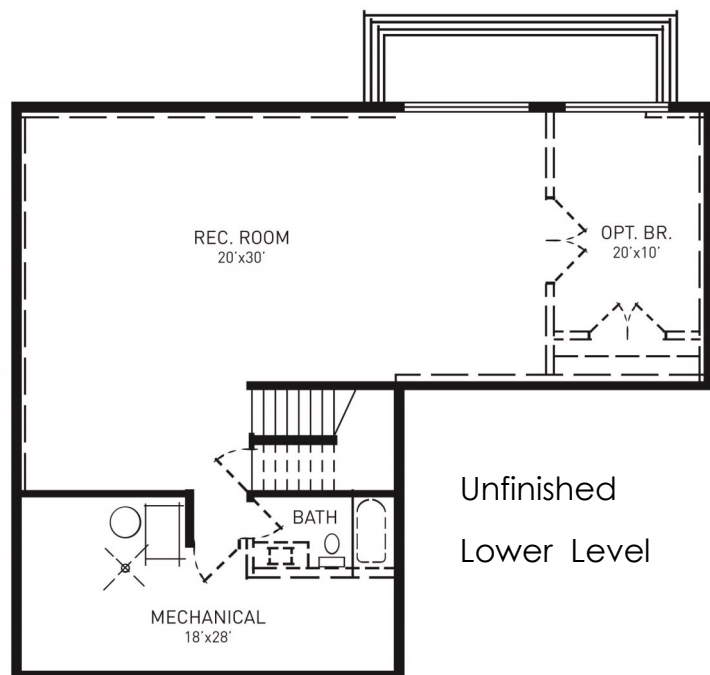

Unfinished
Lower Level

